

OKLAHOMA DEPARTMENT OF TRANSPORTATION					
FED. ROAD DIST. NO.	STATE	JOB PIECE NO.	FISCAL YEAR	SHEET NO.	TOTAL SHEETS
6	OKLA.				
REVISIONS	DESCRIPTION	DATE			
1	OMITTED BRIDGE 'G'	8/15/16			

STATE OF OKLAHOMA
DEPARTMENT OF TRANSPORTATION

PLAN OF PROPOSED
STATE HIGHWAY

DIVISION 3 BRIDGE DRIFT/DEBRIS REMOVAL
FEDERAL AID PROJECT NO. STP-263F(041)3B
STATE JOB NO. 31379(04)

INDEX OF SHEETS

NO.	TITLE
1.	TITLE SHEET
AB01.	GENERAL NOTES AND SUMMARY OF PAY QUANTITIES
B001.	LAYOUT OF DRIFTWOOD REMOVAL - BRIDGE 'A'
B002.	LAYOUT OF DRIFTWOOD REMOVAL - BRIDGE 'B'
B003.	LAYOUT OF DRIFTWOOD REMOVAL - BRIDGE 'C'
B004.	LAYOUT OF DRIFTWOOD REMOVAL - BRIDGE 'D'
B005.	LAYOUT OF DRIFTWOOD REMOVAL - BRIDGE 'E'
B006.	LAYOUT OF DRIFTWOOD REMOVAL - BRIDGE 'F'
△ B007.	(OMITTED)
B008.	LAYOUT OF DRIFTWOOD REMOVAL - BRIDGE 'H'
B009.	LAYOUT OF DRIFTWOOD REMOVAL - BRIDGE 'I'
B010.	LAYOUT OF DRIFTWOOD REMOVAL - BRIDGE 'J'

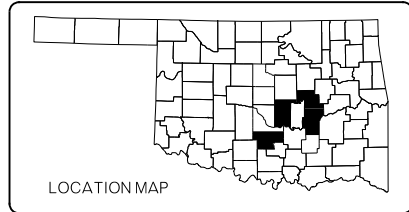

BRIDGE DESIGN
 ASSISTANT SQUAD SUPERVISOR: B. BROWN
 SQUAD MEMBERS: C. ANGER, M. JOHNSON, J. CONWAY, B. BOLES
 D. RAYBURN, D. VAUGHAN, P. HIEMSTRA

 PROJECT ENGINEER: R. SISON, P.E.
 SQUAD SUPERVISOR: N. SHAO

CONVENTIONAL SYMBOLS

- PROPOSED ROAD
- RAILROADS
- RANGE & TOWNSHIP
- SECTION LINES
- QUARTER SECTION LINES
- x- FENCES
- - - GROUND LINE
- - - EXISTING ROADS
- - - BASE LINE
- - - GRADE LINES
- - - TELEPHONE & TELEGRAPH
- - - POWER LINES
- BUILDINGS
- ◆ OIL WELL
- - - DRAINAGE STRUCTURES - IN PLACE
- - - DRAINAGE STRUCTURES - NEW
- - - RIGHT-OF-WAY LINES - EXISTING
- - - RIGHT-OF-WAY LINES - NEW
- - - CONTROLLED ACCESS
- - - RIGHT-OF-WAY FENCE

2009 OKLAHOMA STANDARD SPECIFICATIONS FOR HIGHWAY CONSTRUCTION GOVERN, APPROVED BY THE U.S. DEPARTMENT OF TRANSPORTATION, FEDERAL HIGHWAY ADMINISTRATION, JANUARY 4, 2010.

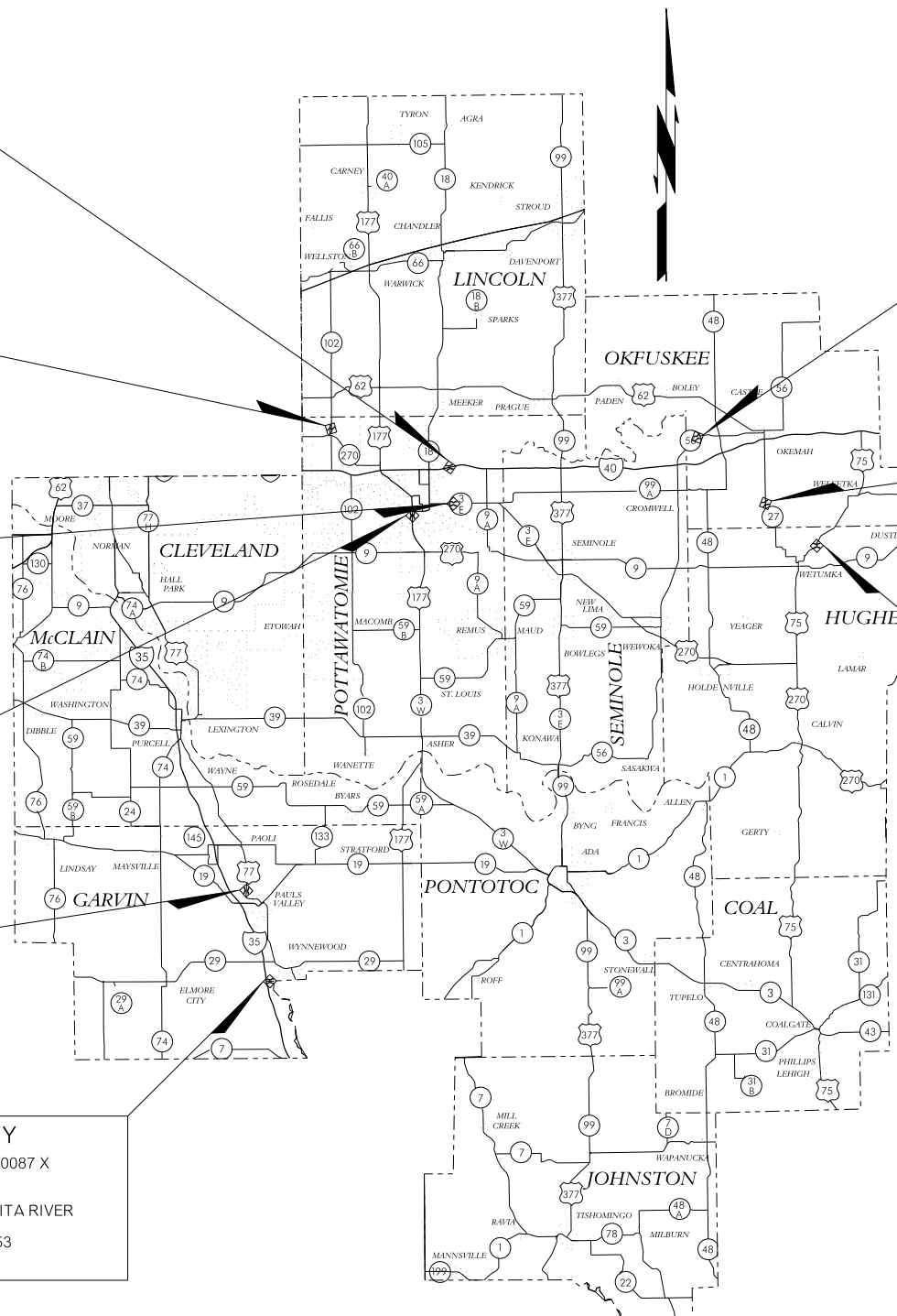

POTTAWATOMIE COUNTY
 BRIDGE 'B' - LOCATION NO. 6341 0269 SX
 NBI NO. 15865
 FACILITY CARRIED: I-40 EB
 FEATURES INTERSECTED: N CANADIAN RIVER
 LOCATION: 2.8 MI E JCT SH 18
 CONTROL SECTION NO. 40-63-41
 SEC. NO. 34 T-11-N R-4-E

POTTAWATOMIE COUNTY
 BRIDGE 'J' - LOCATION NO. 6356 0070 X
 NBI NO. 30017
 FACILITY CARRIED: SH-102
 FEATURES INTERSECTED: N CANADIAN RIVER
 LOCATION: 0.7 N OF JCT US 270
 CONTROL SECTION NO. 102-63-56
 SEC. NO. 9 T-11-N R-2-E

POTTAWATOMIE COUNTY
 BRIDGE 'I' - LOCATION NO. 6304 0227 X
 NBI NO. 19276
 FACILITY CARRIED: SH-3E
 FEATURES INTERSECTED: N CANADIAN RIVER
 LOCATION: 2.2 MI E JCT SH 18
 CONTROL SECTION NO. 03E-63-04
 SEC. NO. 22 T-10-N R-4-E

POTTAWATOMIE COUNTY
 BRIDGE 'A' - LOCATION NO. 6323 0620 X
 NBI NO. 15388
 FACILITY CARRIED: US-270
 FEATURES INTERSECTED: N CANADIAN RIVER
 LOCATION: 3.9 MI S JCT SH 3
 CONTROL SECTION NO. 270-63-23
 SEC. NO. 25 T-10-N R-3-E

GARVIN COUNTY
 BRIDGE 'D' - LOCATION NO. 2502 1239 X
 NBI NO. 16814
 FACILITY CARRIED: US-77
 FEATURES INTERSECTED: WASHITA RIVER
 LOCATION: 5.3 MI S PAOLI
 CONTROL SECTION NO. 77-25-02
 SEC. NO. 1 T-3-N R-1-W

GARVIN COUNTY
 BRIDGE 'H' - LOCATION NO. 2553 0087 X
 NBI NO. 17956
 FACILITY CARRIED: SH-17A
 FEATURES INTERSECTED: WASHITA RIVER
 LOCATION: 0.8 MI E I-35
 CONTROL SECTION NO. 17A-25-53
 SEC. NO. 28 T-2-N R-1-E

OKFUSKEE COUNTY
 BRIDGE 'E' - LOCATION NO. 5414 0233 X
 NBI NO. 22686
 FACILITY CARRIED: SH-56
 FEATURES INTERSECTED: N. CANADIAN RIVER
 LOCATION: 2.5 MI E SEMINOLE CO
 CONTROL SECTION NO. 56-54-14
 SEC. NO. 13 T-11-N R-8-E

OKFUSKEE COUNTY
 BRIDGE 'C' - LOCATION NO. 5408 0398 X
 NBI NO. 28619
 FACILITY CARRIED: SH-27
 FEATURES INTERSECTED: N. CANADIAN RIVER
 LOCATION: 4.2 NW HUGHES C/L
 CONTROL SECTION NO. 27-54-08
 SEC. NO. 19 T-10-N R-10-E

HUGHES COUNTY
 BRIDGE 'F' - LOCATION NO. 3204 2190 X
 NBI NO. 21128
 FACILITY CARRIED: US-75
 FEATURES INTERSECTED: N. CANADIAN RIVER
 LOCATION: 2.9 S OKFUSKEE C/L
 CONTROL SECTION NO. 75-32-04
 SEC. NO. 12 T-9-N R-10-E

PREPARED BY:
 OKLAHOMA DEPARTMENT OF TRANSPORTATION
 BRIDGE DESIGN DIVISION

 R. SISON, P.E.
 OKLA. REG. NO. 23082
 DATE: 8-15-16

ROLAND D. SISON
 LICENSED PROFESSIONAL ENGINEER
 23082
 OKLAHOMA

OKLAHOMA DEPARTMENT OF TRANSPORTATION	DEPARTMENT OF TRANSPORTATION FEDERAL HIGHWAY ADMINISTRATION
DATE APPROVED _____	DATE APPROVED _____
BY _____ CHIEF ENGINEER	BY _____ DIVISION ADMINISTRATOR
SWO _____	PROJECT NO. STP-263F(041)3B
COUNTY MULTIPLE	HIGHWAY MULTIPLE SHEET NO. 1

P.E. NO. : 23285(01)